



IL SOLE

SPECIFICATIONS		ACCOMMODATION			CHARTER RATES	
LENGTH	45m / 147'8	GUESTS	CABINS	CREW	SUMMER	
BEAM	8.82m / 28'11	12	6	9	from	€160,000 + VAT MYBA terms
DRAFT	2.7m / 8'10	CABIN CONFIGURATION			WINTER	
YEAR	1994	REFIT	2019	1 Master	1 VIP	€145,000 + VAT MYBA terms
CRUISING SPEED	16 Knots	3 Double	1 Twin			

SPECIFICATIONS

The Yacht

Length: 45,00M (147'8")
Beam: 8,81M (28'11")
Draft: 3,20M (10'6")
Year Built: 1994
Refit: 2019
Builder: Benetti
Cruising Speed: 15,5 kn
Max Speed: 16,5 kn
Cabins: 6 (3 Double, 3 Twin)
Guests Sleeping: 12
Guests Cruising: 12
Crew: Captain + 9 Crew

Extra Features

Stabilisers at anchor
Stabilisers underway
Jacuzzi on flybridge
Casino roulette table
Solarium Platform
Sky Lounge Theater with HD Projector
Kaleidescape AV System, Blu-ray Vault
SAT TV

Tenders & Toys

6.60m tender 150hp Yamaha, brand new
1 jetski Yamaha FB1800 180hp
1 jetski Yamaha GP1800 250hp (license only / security reasons)
Inflatable toys:

- 1-3 persons banana,
- 1-2 persons couch,
- 1-2 persons donut,
- 1-3 persons inflatable mattress,

Snorkelling gear
Seabobs for kids
New 2020: laqua Divejet Neo (underwater scooter)
Scubagear

This document is not contractual. All specifications are given in good faith and offered for informational purposes only. The publisher and company do not warrant or assume any legal liability or responsibility for the accuracy, completeness, or usefulness of any information and/or images displayed. Yacht inventory, specifications and charter prices are subject to change without prior notice. None of the text and/or images used in this brochure may be reproduced without written consent from the publisher.

[BACK TO THE MENU](#) 

EXTERIORS

[BACK TO THE MENU](#) 









FLYBRIDGE AREA & JACUZZI







AFT DECK LOUNGE AREA



INTERIORS

[BACK TO THE MENU](#) 













MAIN DECK STAIRCASE

























UPPER DECK LOUIS VUITTON DAY HEAD

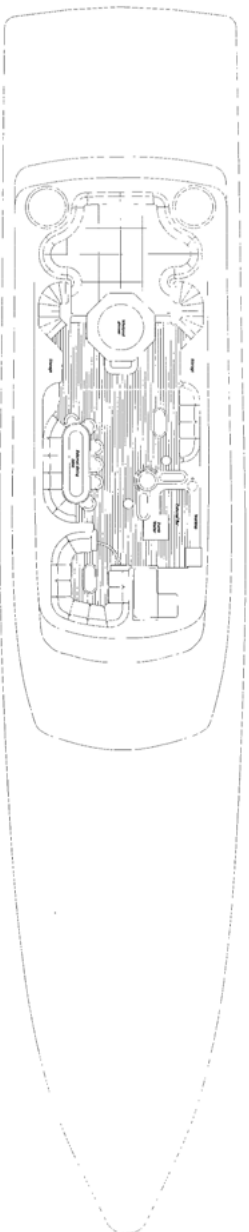

SKYLOUNGE

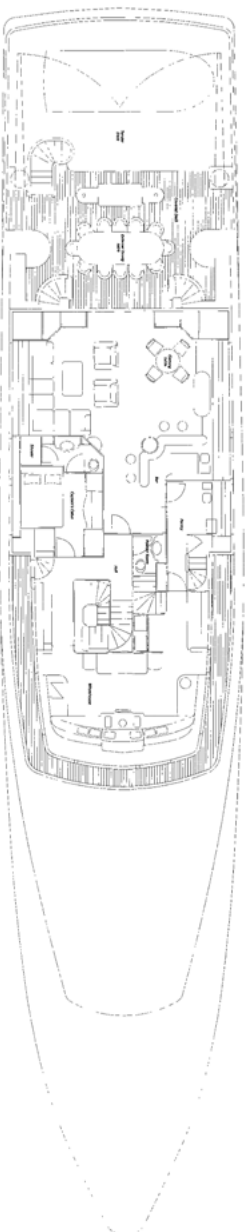

UPPER DECK



MAIN DECK

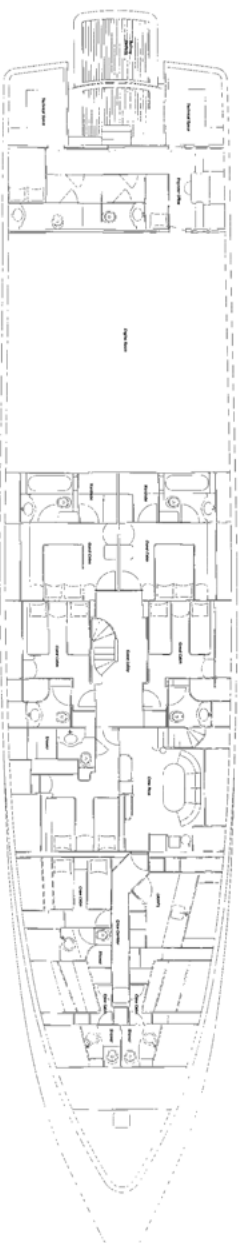

LOWER DECK