

Spirit of MK

109' 11" (33.5m) | CRN | 1980



GENERAL DESCRIPTION

BUILDER	CRN
MODEL	
YEAR BUILT	1980
YEAR REFIT	2021
LENGTH (ft/m)	109' 11" (33.5m)
BEAM (ft/m)	22' (6.69m)
MAIN ENGINES	2 x MTU - 1000hp
CRUISING SPEED (kn)	13
MAX. SPEED (kn)	15
FLAG	Spanish
LOCATION	Spain/Alicante
VAT STATUS	Paid
CABINS/GUESTS	5/12
ASKING PRICE	€1,890,000

Spirit of MK

109' 11" (33.5m) | CRN | 1980

MAIN CHARACTERISTICS

BUILDER	CRN
MODEL	
EXTERIOR DESIGNER	CRN Spa
FUEL CAPACITY	38000 liters
WATER CAPACITY	10000 liters
RANGE (CRUISING) NM	3200
LENGTH	109' 11" (33.5m)
BEAM	22' (6.69m)
DRAFT	9' 3" (2.8m)
GRT	163
HULL TYPE	Displacement
HULL MATERIAL	Steel
STRUCTURE MATERIAL	Aluminum
FUEL TYPE	Diesel

Spirit of MK

109' 11" (33.5m) | CRN | 1980

OVERVIEW

A rare opportunity to purchase a meticulously maintained classic vessel, 33.5m (109'11") M/Y SPIRIT OF MK casts an elegant shadow across the water. She is a pedigree build with a high-volume interior and generous amount of deck space.

Key Features

- Comprehensively refitted in 2021
- Timeless, classic design
- Expansive flybridge
- Large Salon and living spaces
- Excellent charter potential
- 5 guest cabins

Spirit of MK

109' 11" (33.5m) | CRN | 1980

ACCOMODATION

GUEST	12
CREW	5

Spirit of MK

109' 11" (33.5m) | CRN | 1980



Spirit of MK

109' 11" (33.5m) | CRN | 1980



Spirit of MK

109' 11" (33.5m) | CRN | 1980



Spirit of MK

109' 11" (33.5m) | CRN | 1980



Spirit of MK

109' 11" (33.5m) | CRN | 1980



Spirit of MK

109' 11" (33.5m) | CRN | 1980



Spirit of MK

109' 11" (33.5m) | CRN | 1980



Spirit of MK

109' 11" (33.5m) | CRN | 1980



Spirit of MK

109' 11" (33.5m) | CRN | 1980

GENERAL ARRANGEMENT

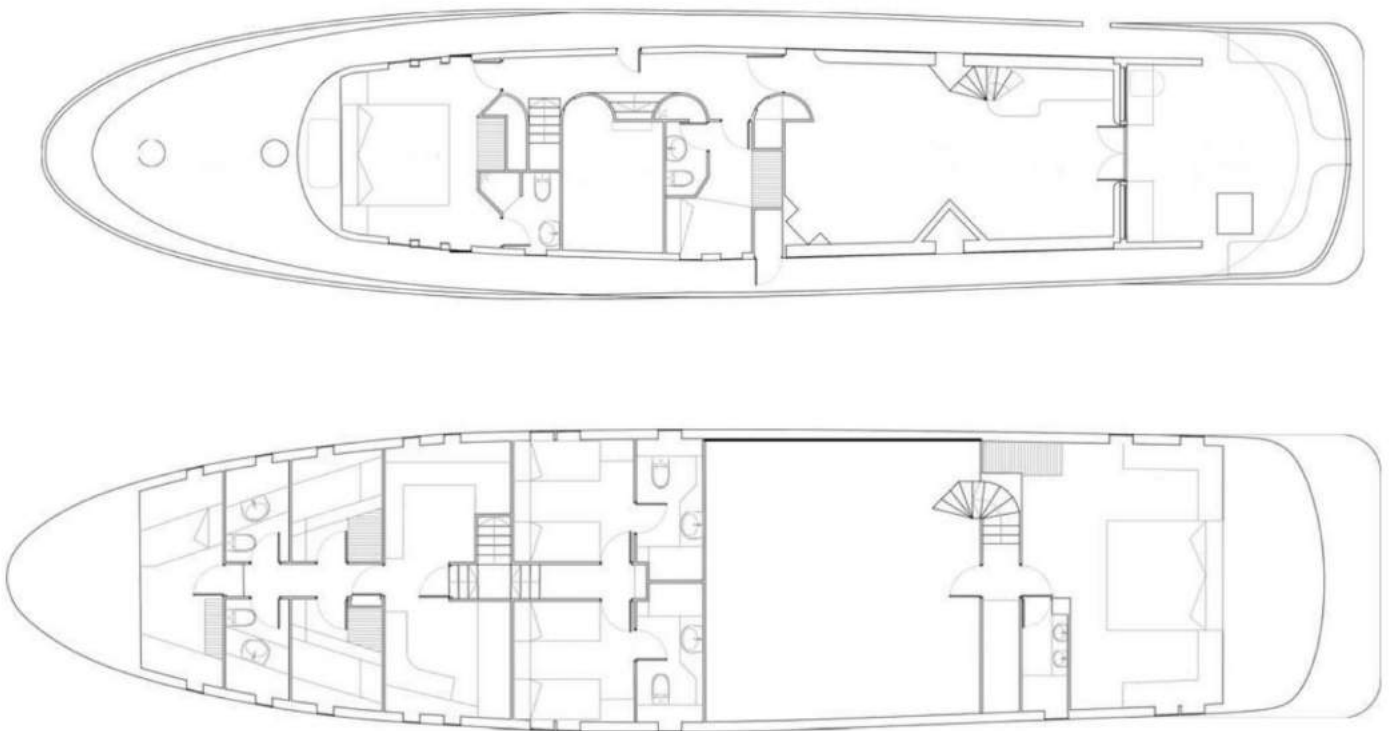

Spirit of MK

109' 11" (33.5m) | CRN | 1980

ACCOMODATION

- Full-width master cabin aft on lower deck with en-suite bathroom
- Three twin guest cabins on lower deck both with en-suite bathrooms
- Fully equipped galley on the lower deck
- 1x Captain's cabin on main deck amidships with ensuite bathroom
- 3x Crew forward cabins for 3-5 crew on the lower deck
- VIP cabin/second master cabin forward on main deck
- Main Saloon on main deck level

Accommodation Finish:

- Wooden floor
- Cherry furniture
- Carpet floor in crew cabin

Accommodation Features in Detail:

Master cabin:

- Chair
- 2x Bed lights
- 2 x Table with drawers
- 4x drawers
- 4x port holes
- Bed headboard mirror
- Ceiling lights
- Cherry furniture
- Wooden floor

Master cabin ensuite bathroom:

- Double sink with golden tap water mix
- Double door mirrored cupboard
- 2x Lower double door cupboard
- Shower
- Electric WC

!breakPage

!breakPage2 x Twin cabins:

- 2x Single beds
- Moquette floor
- 2x port holes
- 3x bed drawers
- Mirror

Spirit of MK

109' 11" (33.5m) | CRN | 1980

2 x Twin cabins ensuite bathrooms:

- Shower with wooden floor board
- Single wash basin
- Electric WC

VIP Cabin:

- 1x Double bed
- 2x Table with drawers
- Table mirror
- 2x Bed lights
- Blue bed headboard in leather
- 4x port holes
- Ceiling lights
- Wooden floor

Saloon

- Settee sofa to port side
- Ceiling lights
- Dining table accommodating 8 guests
- Large comfortable chairs
- Library
- Lower cupboards
- Side Windows
- Wine cellar
- Wooden dining table for 8 persons
- Wooden floor

Galley

- Lower cupboards and drawers
- Portholes
- Sink with water tap
- Table with chairs
- Teak wooden floor

!breakPage

Captain cabin

- 2x port holes
- 3/4 bed
- Ceiling lights
- Audio Speaker

Captain bathroom

Spirit of MK

109' 11" (33.5m) | CRN | 1980

- Bathroom with shower
- Single wash basin with water tap

2x Crew Cabins:

- 2x single pullman beds
- Ensuite bathrooms with WC and Shower

Spirit of MK

109' 11" (33.5m) | CRN | 1980

TENDERS & WATERSPORT EQUIPMENT

- Seadoo Jetski
- 4x stand-up paddle boards
- One seater doughnut
- Four-seater doughnut
- Two-seater banana and numerous other towables
- Anti Jellyfish floating swimming pool
- 10x Snorkel Kits
- 3x Underwater Scooters and a deep board

Spirit of MK

109' 11" (33.5m) | CRN | 1980

MACHINERY

Engine & gearbox:

- 2x MTU 8V 331TC81 8-cylinder diesel engines producing approx 1.000 Hp each
- Reduction gearboxes
- Single lever throttle/gear controls

Maintenance & Performance:

- Engine hours: 2.700 hours as of Spring 2022 Mtu completed W5 revision 2003 zero hour
- Engine serviced annually – last service Spring 2022
- Cruising speed: approx. 13 knots
- Maximum speed: approx. 15 knots
- Max range: Approx 3,200 Nm @ 12 Knots
- Consumption: Approx 160 litres per hour

Propulsion & Steering:

- Four-bladed propellers driven through stainless-steel shafts
- Hydraulic bowthruster
- Hydraulic steering system
- C. Plath rudder indicators and flybridge and lower helms

Stabilisers:

- Hydraulic fin stabilisers with Koopnautic FAL 124 control units

Spirit of MK

109' 11" (33.5m) | CRN | 1980

GENERATORS & AUXILIARY SYSTEMS

Generator:

- 2x Onan 60 kW - 75 KVA Voltages: 380V AC / 220V AC / 24V DC – Replaced 1996
- Generator hours: Approx 27.800 and 30.600 as of Spring 2022
- Generators serviced annually – last service Spring 2022 Battery Chargers:
- 1 x 24/40-3 all in one Victron charger for service batteries
- 1 x Mastervolt CHARGEMASTER 24V 40A, 3 output (Masterbus Czone) M718F0149
- 1 x Mastervolt Current Converter & Battery Charger MAC PLUS 24V/12V-50
- 1 x Victron Generator battery charger
- 1 x Victron charger for emergency batteries Alternators:
- Engine-mounted alternators for charging engine start batteries Shorepower:
- 380vAC and 220vAC shore power system
- Ring-main with 220vAC sockets throughout yacht

ELECTRICAL SYSTEMS

- Voltage systems:
- 24vDC primary domestic system with 220v AC via shorepower, generators or inverters
- Battery Banks:
- 2x 12V 85Ah GEL Batteries – 2021
- 4x 12V 190Ah Promotive Efb – 2021
- 4x 12V 120Ah GEL Batteries – 2021
- 4x 12V 200Ah AGM Batteries – 2021

Spirit of MK

109' 11" (33.5m) | CRN | 1980

COMMUNICATION EQUIPMENT

- 2x Sailor mod. 6222. 12-24V VHF DSC Class A – 2021
- Waterproof Remote control unit SAILOR mod. 6204 for VHF SAILOR 6210 and 6222 – 2021
- Sailor BLU GMDSS MF-HF model 6310 – 2021
- Furuno FR 1510 MARK-3 radar (2003) • GOFREE Wi-Fi 1 Module with 4G and Wi-Fi repeater – 2021
- Inmarsat Mini M. TT-3064A Maritime Capsat telephone & fax – 2003
- Inmarsat SAT C TT-3020C Maritime Capsat transceiver system – 2003
- NAVTEX navigational warning receiver LCD display – 2021 • Router 3G/4G/ Wi-Fi with Dual Sim – 2021
- 2.4 GHz 10 dB Omnidirectional Wi-Fi Antenna – 2021
- 4dBi Wideband 3G/4G/LTE Antenna – 2021 • AIS/VHF/FM Plotter with 12dB AIS Amplifier and Antenna – 2021
- AIS/VHF/FM Splitter with 12dB AIS amplifier and antenna VSWR indicator – 2021

Spirit of MK

109' 11" (33.5m) | CRN | 1980

NAVIGATION EQUIPMENT

- Simrad EVO3S Combo World Basemap Full HD 16-inch display – 2021
- Simrad EVO3S Combo World Basemap Full HD 12-inch display – 2021
- 2x Simrad OP50 Remote controls with MOD function – 2021 • Simrad HALO-6 plus compression radar – 2021
- Furuno secondary radar - 2003 • Navionics Gold XL9 Charts for Mediterranean and Black Sea – 2021
- HS60 GPS Compass – 2021
- Simrad NAC-2 Autopilot computer – 2021
- 2x Simrad AP44 Autopilot controller – 2021
- JMC Super pilot Max III solo plotter – 2021
- B&G Wind Sensor 608 – 2021
- 3x Simrad wind, speed and depth digital displays – 2021
- XB-6000 Class B AIS with NMEA 2000 gateway and built-in GPS antenna – 2021
- Max Sea Time Zero plotter running over PC with input from GPS incl sea map system Garmin 75

Spirit of MK

109' 11" (33.5m) | CRN | 1980

DECK EQUIPMENT

Exterior cockpit Layout:

- Comfortable aft seating with cushions for lounging around the stern
- L-shaped sofa ideal for enjoying sundowners
- Cockpit table accommodating 12 guests
- Ceiling lights Awnings and covers:
- Covers • 2x Flybridge bimini

General:

- Air Compressor BOGE 250 l/min (1989)
- Cockpit Grill TECHIMPEX
- ITV Icemaker
- 2x deck wash systems
- 2x Side opening access doors in superstructure
- Bathing ladder
- Bathing platform access ladders
- Carbon fiberglass manual gangway
- Deck shower
- Foldable table on flybridge for 12 persons
- Heavy duty fiberglass Gangway for in-harbor use
- Outdoor Cinema
- Sun loungers
- Fold-out teak laid bathing platform
- Wetbar

Anchoring & Mooring:

- 2 x Electric anchor windlass used also as mooring capstan
- 2 x Anchors at bow
- 2 x stern capstan winches for mooring

Spirit of MK

109' 11" (33.5m) | CRN | 1980

GALLEY & DOMESTIC EQUIPMENT

Galley:

- Balay 5-ring ceramic hob
- Bosch Fridge- Freezer two doors
- Bosch Grill/oven
- Bosch Microwave grill
- Miele dish washer
- 220vAC galley hood
- Zanussi Dishwasher
- 2x Domestic fridges
- Domestic freezer
- 3x Mini fridges

Heads:

- 4 x 24V Stiloplus electric heads - 2021
- Hot & cold pressurised showers in bathrooms Heating & Ventilation:
- Frigomar 50.000 BTU unit, reverse cycle chiller inverter air-conditioning system – 2021

Laundry:

- EAS Electric EMTD81P washing machine
- EAS Electric dryer

Entertainment:

- TV systems in saloon, all guest cabins and on deck
- JL Mediamaster MM100S-BE1 x Blue Ray Samsung
- JL marine speaker system with amplifier and subwoofer
- Harman Kardon Hi-Fi tower with Bose speakers in main salon

Spirit of MK

109' 11" (33.5m) | CRN | 1980

SAFETY & SECURITY EQUIPMENT

Lifesaving:

- Sailor 406 MHz EPIRB – 2013
- 1 x IP Dome camera DAHUA Star Light 5 Megapixel Wide Angle Fixed Lens IR Leds 30 meters
- 12 x Life jackets for adults
- 14 x Avon automatic life jackets with safety harness
- 2 x Camara IP CAM-1 Stainless Steel 12V DC (or POE+) – 2021
- 2 x LALIZAS life rafts, each for 12 persons SOLAS B pack (next Service due June 2022)
- 6 x Life jackets for children • Anadir-Thron 30S MKII 121,5/406 MHz (flybridge) RT9-3 MC Murdo 9 GHz SART
- Automatic detectors with central control on the bridge
- Capsat message handling program (2003)
- Engine room & forward flood bilge alarms
- Searchlight on top of flybridge
- Smart Detection with Integrated microphone – 2021

Fire control:

- Manual fire extinguisher on the main deck – Serviced 2022
- Closing valves for fuel in engine room – Serviced 2022
- FM200 Action fire extinguisher in engine room – Serviced 2022

Spirit of MK

109' 11" (33.5m) | CRN | 1980

REFIT SUMMARY

2022 Refit works:

- Cabins • New TVs • 2 Pullman beds • New shower box • New curtains colour • New shower floor for the showers • New bed linen • New towels • New furniture
- Saloon • New puffs settee • New audio system
- Interior • All the interior woods treatment • Interior fully repainted • New closed phone system • New crockery • All the fan coils got serviced and the ones that needed replacing got replaced • Metals re-galvanised
- General • Wi-Fi signal got expanded
- Flybridge • New TV • 3 x new puffs settee • 1 x extra Jet ski • New awnings • New railing • New dishwasher • New fridge • More lightning • New paint patch jobs • New table for 12 guests • New extra chairs • New stair
- Bridge • 2 x new captain chairs • 2 x more screens • Extra lighting • Extra charts • New table • New shelves • New stairs • New wipers
- Engine room • New sound insulation • New engine room paint • New water heater • New tanks gauges • Two more air conditioning units • More pumps • More lighting • New wardrobes Deck • New swimming platform • New swimming ladder • New gangway • New sofa settee on the bow
- Deck • New swimming platform • New swimming ladder • New gangway • New sofa settee on the bow • New solarium • New teak treatment • New polish of the windows • Extra audio speakers • New table in the aft deck for 12 guests • New polish of the alloys • Bulwark and superstructure painted and polished • Extra chairs • New gunwale varnish • New Leds around the deck • Extra sockets • CCTV Camara • New covers for the outdoor elements • New custom bow settee with integrated audio speakers
- Below deck and hull :• Anchor chain repainted • New hull patch paint jobs • New hull polish • New Antifouling • New generators exhaust • New generators service
- Engines service • New Fire extinguish system service • New axis service • New Life rafts service • New cooling system service

!breakPage

2021 - Comprehensive Refit comprising:

Spirit of MK

109' 11" (33.5m) | CRN | 1980

- Guest Cabins • New mattress • New headboards • New bed clothes • New curtains
- Saloon • New wine cellar • New sofa • New TV • New wood curtains
- Interiors • All the bathroom's floors changed to marble floors • All the toilets replaced • Full interior painted • Leather ceiling's redone • Led lights on the steps of the stairs • Metals re galvanised • New crockery and cutlery • New kitchen with new appliances • New wood floor • Joinery and varnish restoration
- General • Fire extinguisher service • Rewired • New life rafts • New lights • New TVs • New Wi-Fi system
- Flybridge • All navigation screens replaced • Crane completely refitted • New bar • New entertainment system • New Icemaker • New Jet ski • New kitchen • New sofas • New table • New teak • New tender • New water toys
- Bridge • New navigation equipment (All replaced) • New telecommunication systems • New sofa • New radar
- Engine room • Engines fully serviced • Generators fully serviced • Water maker fully serviced • New pumps • New pipes • New batteries • New air-conditioning system • New sound proofing boxes for the generators • Bow thruster fully serviced • New exhaust • New bow-thruster pump
- Deck • New speakers • New table • All the alloys polish • New chairs • New handrail pulpit varnish
- Below deck and hull • Full service of the tanks • New ceiling of some of the tanks • Hull sand-blasted and re-painted as required • Anchor chain repainted • Installation of underwater lights

2017-19 Refit works:-

- New Air conditioning reverse cycle with inverter • New GPS • New battery chargers • New watermaker • New Generator head gaskets

2014-2016 refit works:

- New Hull and superstructure paint • New batteries • Water tank service • New hydraulic crane refit

2011-2013 refit works:

- New Air conditioning reverse cycle unit • New teak on the aft deck (18 mm left) • New water heating system for the main engines installed by MTU

2008-2010 refit works:

- New deck foldable table accommodating 8 persons • New teak bathing platform • New bathing platform access ladders

Earlier 1994-2006 refit works:

- New Heavy duty stabilizers software upgrade • New engines (1992) • New plotter • New VHF Radios • New radiotelephone & printer • New Autopilot • New Generators • New Depth ecosounder • New marine transceiver • New radar • New weather receiver & Navtex

Spirit of MK

109' 11" (33.5m) | CRN | 1980

TANK CAPACITIES

Fresh Water:

- Multinox-N-80/48-M Boreak pump system for water system
- 2 x Hot water of 200 l supplied via engine cooling with calorifier or via 230vAC immersion heater element from shore power in well-insulated hot water tank

Watermaker:

- AQUA R.O. 24v DC / 220v 50Hz 20VA. Ev.P. constant pressure reverse osmosis watermaker producing approx. 160 lph
- Bilge Pumps:
 - Engine driven bilge pumps
 - 2 x automatic electric bilge pumps
 - 1 x manual electric bilge pump

Black & Grey Water:

- Grey and black water discharges to holding tanks